

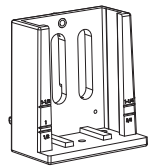

## Drill Guide Block

Item# K3DGB

**WARNING:** This product can expose you to chemicals including Carbon 1333-86-4, which are known to the State of California to cause cancer. For more information go to [www.P65Warnings.ca.gov](http://www.P65Warnings.ca.gov).

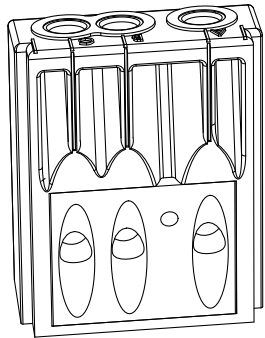

PORTABLE BASE

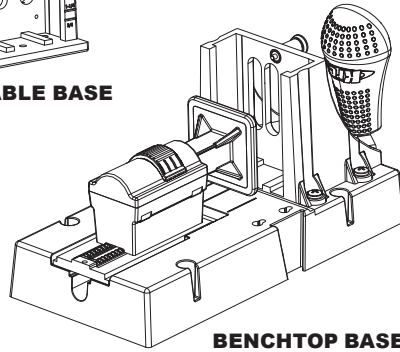

BENCHTOP BASE

The Kreg® Drill Guide Block is designed for use with the Kreg Jig® K4, K4MS, K5, and K5MS benchtop bases and the Kreg Jig® Portable Base.



KREG TOOL COMPANY  
201 Campus Drive  
Huxley, Iowa 50124

[www.kregtool.com](http://www.kregtool.com)

800.447.8638

NK7533  
Version 2 - 06/2018

### ADJUSTING THE DRILL GUIDE

For a strong joint, the screw should exit close to the center of the workpiece thickness. To adjust the pocket-hole position, disengage the drill-guide locking pin on the benchtop or portable base. Then raise or lower the drill guide until the mark on the side of the guide that matches the thickness of the workpiece is even with the top of the guide socket. Re-engage the locking pin.

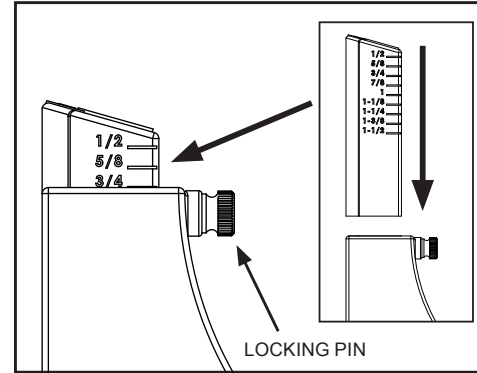

Drill-Guide block positioned for 3/4" thick material.

### USING THE DRILL GUIDE BLOCK SEPARATELY

In situations where clamping the drill guide block in place is not possible, you may screw the drill guide directly to the workpiece with two Kreg SML screws.

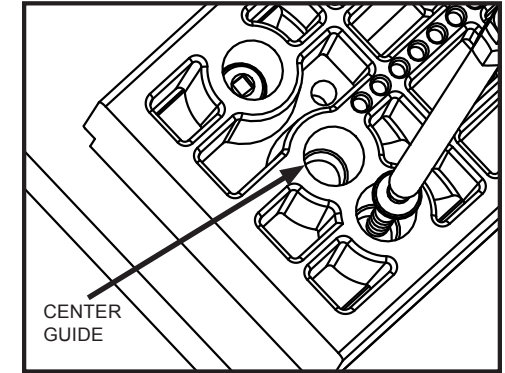

**ATTENTION:** With the drill guide block screwed to the workpiece, use the center drill guide.



## Drill Guide Block

Item# K3DGB

**WARNING:** This product can expose you to chemicals including Carbon 1333-86-4, which are known to the State of California to cause cancer. For more information go to [www.P65Warnings.ca.gov](http://www.P65Warnings.ca.gov).

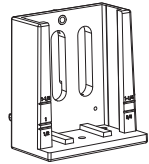
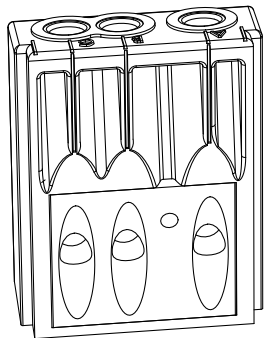

PORTABLE BASE

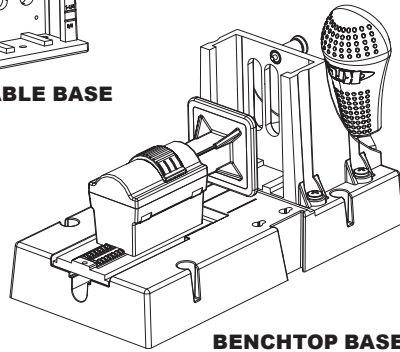

BENCHTOP BASE

The Kreg® Drill Guide Block is designed for use with the Kreg Jig® K4, K4MS, K5, and K5MS benchtop bases and the Kreg Jig® Portable Base.



KREG TOOL COMPANY  
201 Campus Drive  
Huxley, Iowa 50124

[www.kregtool.com](http://www.kregtool.com)

800.447.8638

NK7533  
Version 2 - 05/2018

### ADJUSTING THE DRILL GUIDE

For a strong joint, the screw should exit close to the center of the workpiece thickness. To adjust the pocket-hole position, disengage the drill-guide locking pin on the benchtop or portable base. Then raise or lower the drill guide until the mark on the side of the guide that matches the thickness of the workpiece is even with the top of the guide socket. Re-engage the locking pin.

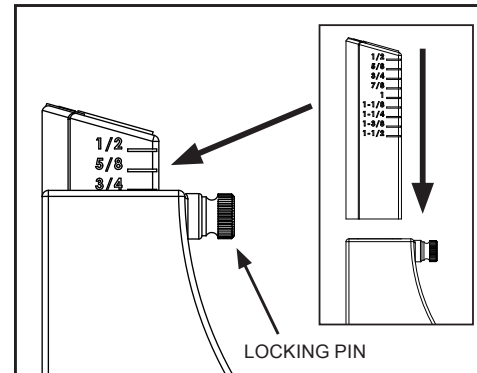

Drill-Guide block positioned for 3/4" thick material.

### USING THE DRILL GUIDE BLOCK SEPARATELY

In situations where clamping the drill guide block in place is not possible, you may screw the drill guide directly to the workpiece with two Kreg SML screws.

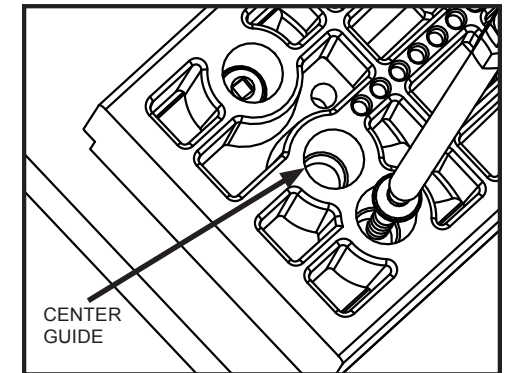

**ATTENTION:** With the drill guide block screwed to the workpiece, use the center drill guide.