

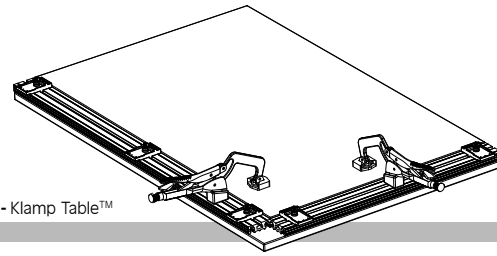

# Klump Table™ Instructions

Online: [www.kregtool.com](http://www.kregtool.com) • Phone: 800.447.8638  
Email: [customerservice@kregtool.com](mailto:customerservice@kregtool.com)

ITEM# KKS1000 - Klump Table™



### Items Included:

- (1) Table Top
- (1) Table Base
- (8) 1-5/8" flat-head wood screws
- (40) 1/4"-20 x 1-1/4" Truss Head Bolts
- (40) 1/4"-20 Hex Nuts
- (2) Bench Klumps
- (5) Klump Blocks

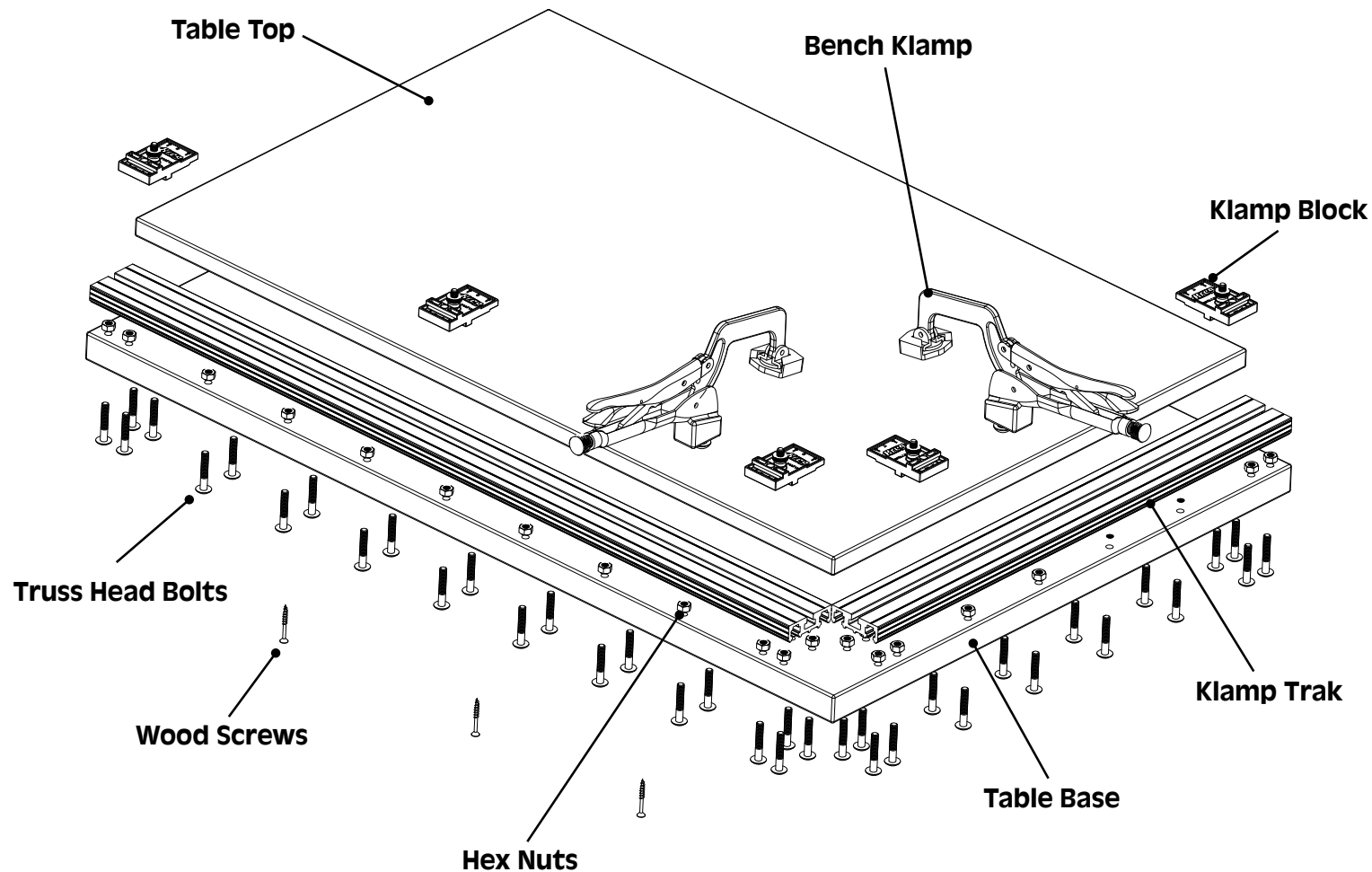

\*Not all parts shown.

## Klump Table™ Assembly

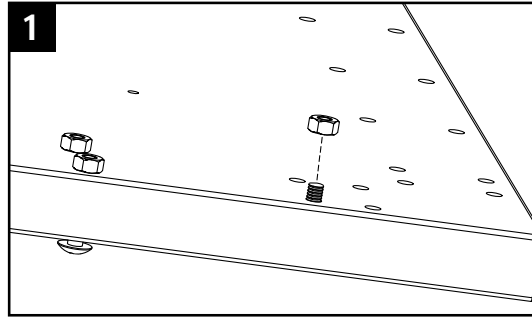

### STEP ONE

Begin by positioning the **Table Base** at the corner of your workbench so that the pre-drilled holes hang over the surface with the countersunk side facing down. Insert the **1/4-20 x 1-7/16 Truss Head Bolts** up through the countersunk holes on the bottom side of the **Table Base** and thread on the corresponding nuts until the bolts are flush with the top of each nut, **as shown in image 1**. There are 38 holes in total.

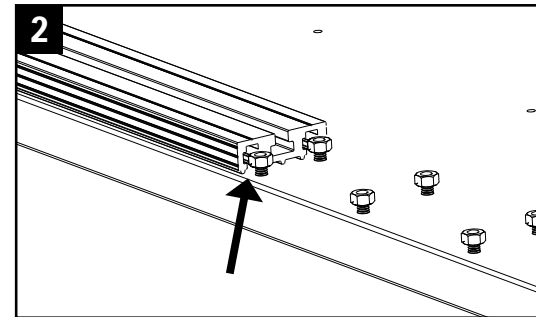

### STEP TWO

With all the bolts inserted and nuts threaded on, begin guiding both pieces of **Klump Trak™** over the bolts; raising, lowering, and rotating them as necessary, **as shown in image 2**. Once the trak has been positioned, do NOT tighten the bolts down. You will need to make adjustments to the Trak's position after the next step.

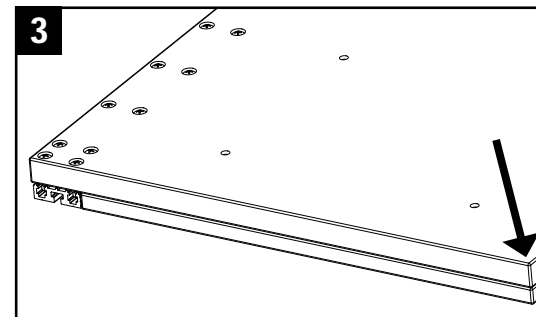

### STEP THREE

With both lengths of Trak in place (but not yet tightened down), place the 3/4" **Table Top** face-down on your work surface so that the pre-drilled holes are visible. Then, while securing each length of Trak with your hands, carefully flip the **Table Base** and **Klump Trak™** assembly and place it face-down over the **Table Top** so that the Top rests in the space between the Trak lengths. Next, slide the **Table Base** assembly slightly so that the corner of the Top and Base opposite the Klump Table™ sticker is perfectly flush, **as shown in image 3**.

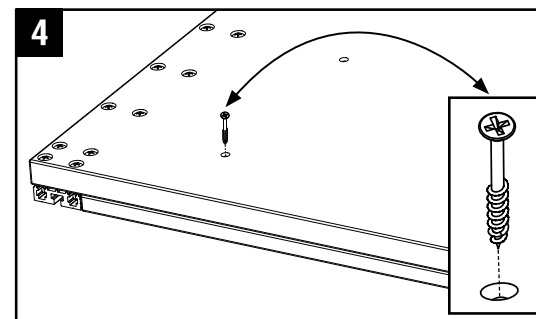

### STEP FOUR

With the two tables lined up, you should now be able to install the flat-head screws and join them together. Place the eight 1-5/8" flat-head screws in the pre-drilled holes of the **Table Base** and make sure that screw tips fall gently into the pre-drilled holes of the **Table Top**. If all eight screws fall into the holes on the Top you are assured the table surfaces will be lined up properly. You may begin to drive the screws **as shown in image 4**, using a #2 Phillips Driver. For an optimum hold, and to reduce the possibility of damage to the table's surface, do not overdrive the screws.

After the Table Top and Table Base are secured to each other, push the **Klump Trak™** towards the center of the assembly until it lays snug against the **Table Top** and flush to the outside edges. Once the Trak is positioned, use a #3 Phillips driver to tighten the bolts down completely, securing the Trak into place. Repeat this step for the second length of Trak.

### NOTE

Ensuring that the two lengths of Klump Trak™ are perfectly perpendicular (90 degree angle) to each other will give you the best possible results when using the included Klump Blocks™ to align face-frames and other project stock. For a more accurate 90 degree angle, you may use a combination square (instead of the Table Top) to align the Trak.

## Klamp Blocks™ Instructions

### Introduction

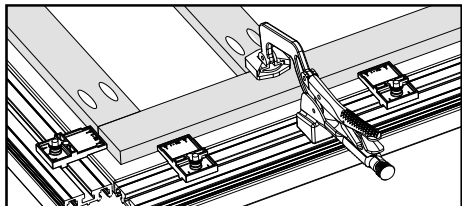

Our Klamp Blocks™ are designed to allow for quick registration of your workpieces to the edge of the Klamp Trak™ and to precisely center joints under the Bench Klamp's™ rubber pad.

### Getting Started

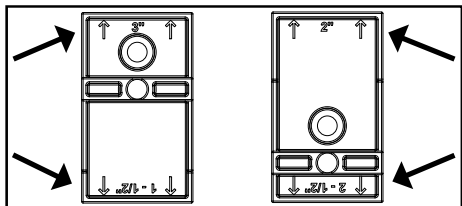

To center the Bench Klamp™ on joints in a repeatable fashion, the Klamp Blocks™ must first be set correctly. There are 4 dimensions listed on each Klamp Block™ (1-1/2", 2", 2-1/2", 3"), which relate to the width of your stock to be joined. For instance, if you are working with 1-1/2" wide stock, positioning your blocks with the 1-1/2" marking adjacent to the stock will place the center of your Bench Klamp™ on the joint line between mating workpieces.

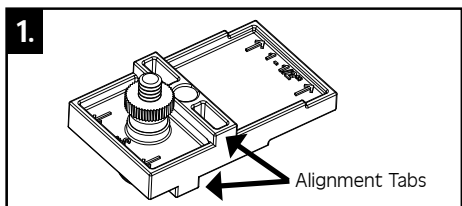

To set your Klamp Blocks™, start by finding your stock's width and locating the same dimension on your Klamp Block™. (We will be using 1-1/2" wide stock in this example.) Then, insert the t-bolt into the Alignment Tab opposite the marking, **as shown in image 1**. Once the Bolt is through, thread the plastic nut onto the bolt so that the bolt slightly protrudes from the other side. Repeat as necessary to the remaining Klamp Blocks.

### Clamping a Joint

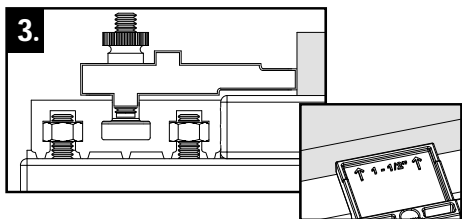

With the correct marking facing your workpiece, insert your Klamp Block™ into the t-slot of the Klamp Trak™, **as shown in image 3**.

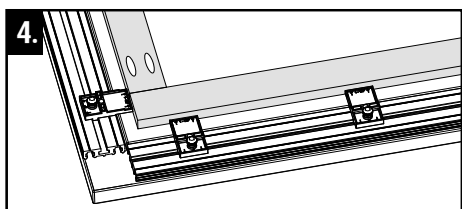

The Klamp Block™ will now slide in either direction along the length of the trak. Position the block in its desired location and lock it into place by tightening the plastic nut. Add a second block to the trak and slide your workpiece up against them, parallel to the trak, **as shown in image 4**.

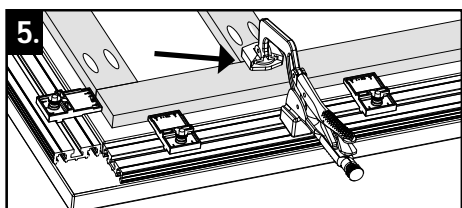

Now that your workpiece is in place parallel to the Trak, the center of the Bench Klamp's™ clamp pad will be perfectly centered on the far side of the workpiece, making it easy to clamp on the center of any joint. This is especially useful for Pocket-Screw Joinery, **as shown in image 5**.

## Bench Klamp™ Instructions

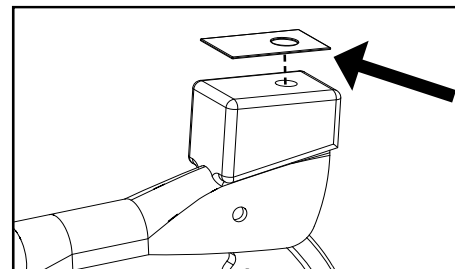

### The Glide Pad.

This pad allows the Bench Klamp™ to slide smoothly across the Klamp Trak™ and Klamp Plate™. Begin by using a dry cloth or paper towel to remove any excess oil from the base of the Klamp. Separate the Plastic Glide Pad from its paper backing. Then, carefully center and adhere the pad to the base of the Bench Klamp™, as shown at left. Any part of the pad which extends beyond the Bench Klamp™'s base may be trimmed off.

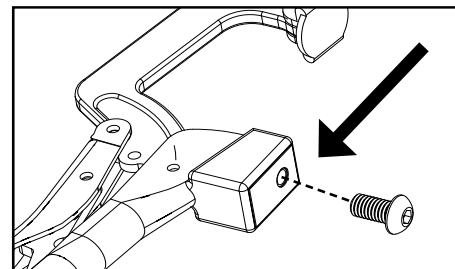

### The Anchoring Screw.

This Inter-Lok Anchoring Screw serves as the foundation of the entire Klamp System™. With it, the Bench Klamp™ can be moved to the Klamp Plate™ and Klamp Trak™ quickly and easily, and removed again to retain a flat work surface. Begin by threading the Anchoring Screw into the base of the Bench Klamp™. Start with the Anchoring Screw roughly 1/2 of the way in, and test the fit on the Klamp Plate™ or Klamp Trak™. Continue to adjust the Anchoring Screw until it 'slip-fits' into the slot without difficulty, and still rotates freely.

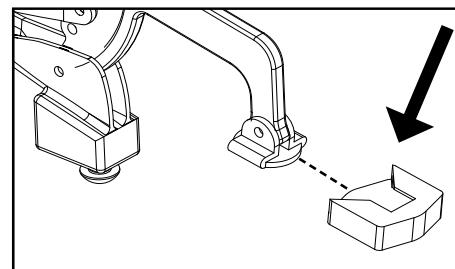

### The Clamp Pad.

The Clamp Pad protects your workpieces from being marred or otherwise damaged by the Bench Klamp™. Depending on the type of work you are doing, and the hardness of your stock, you may add or remove the Clamp Pad at your discretion.

## Klamp Table™ Maintenance

### Cleaning

The slick melamine coating on the Table Top does a good job of resisting glue but may need some basic cleaning from time to time. Cleaning the surface frequently and keeping it free from build-up will lengthen the life of the top and keep the surface as smooth/useful as possible. For additional protection against glue, we recommend coating the surface with Bates Glue Release (1-888-363-2628). Be sure to follow the respective product's directions during application.

### Replacement Top

In the event that a replacement top for your Klamp Table™ is required, contact Kreg directly. Our customer service professionals will be able to help you order your replacement top and will get it sent to you as soon as possible.

800.447.8638  
customerservice@kregtool.com